

Touch-Gloves

Forget cold fingers when swiping this winter!



Instructions

1. Find your touch point: Place the adhesive dot on your mobile's display with the adhesive side facing up and touch it with the fingertip of the glove. Circle the adhesive dot with tailor's chalk and then remove it.
2. Turn the glove to the left side.
3. Take the thread 3 times, thread it and sew it up in the seam.
4. Push through the needle to the inside and try catching the edge of the spot. Put the wooden stick in your glove's finger to help pushing through.
5. Turn the glove to the right and insert the wooden stick back.
6. Embroider the star. It is important that the thread goes right through to the inside and does not get stuck in the lining!
7. To sew up after the last stitch, push through the needle again, turn the glove to the left, sew up the thread with the middle of the star, and finish with a knot.
8. Turn your glove back to the right - done!

the star stitch:

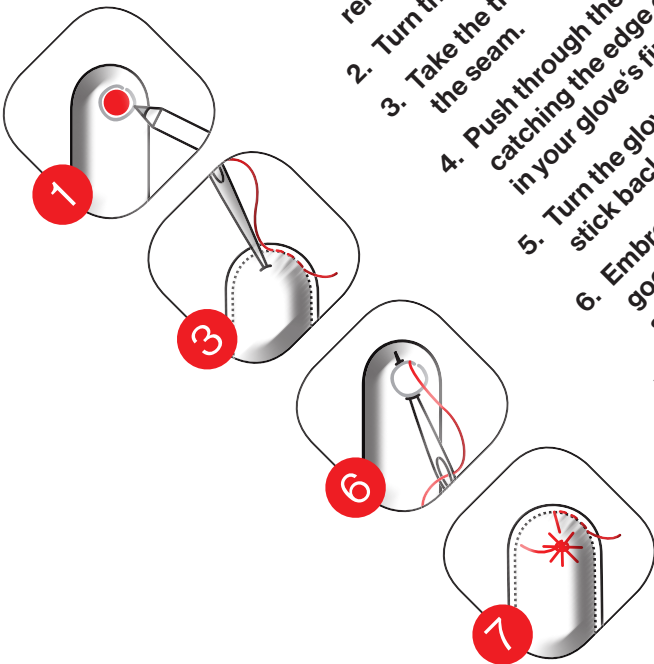
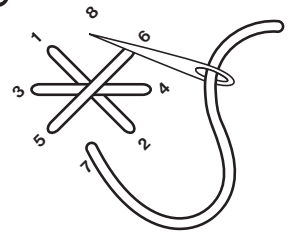

do it yourself!

Re-connect your finger with your smartphone!

This manual is also an envelope in which thread, needle and sticks can be stored.

► Print double-sided, cut out along the dotted lines and fold (instructions on the back).

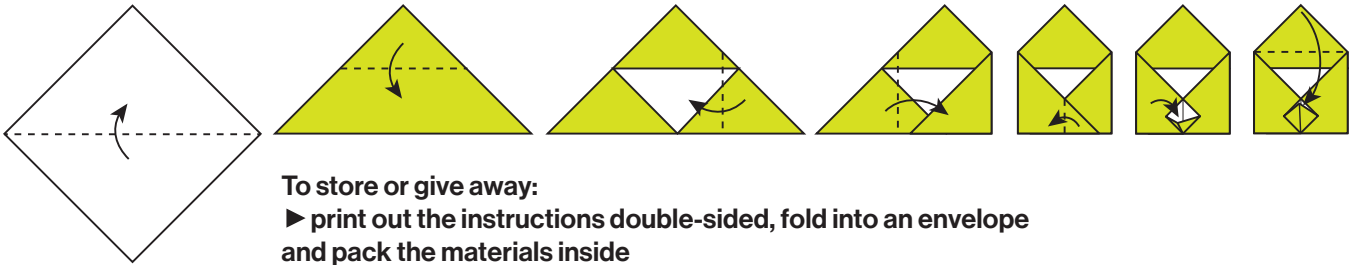

To store or give away:

- ▶ print out the instructions double-sided, fold into an envelope and pack the materials inside

Touch gloves

Forget cold fingers this winter!

H3K
House of Electronic Arts
Basel

Supplier for conductive yarn:
www.bart-francis.be
ET inox SEW 2ply

Why can't I operate my Smartphone with gloves on?

Touchscreens of mobile phones and tablets operate via an electromagnetic field located under the surface of the screen. Since humans are also a bit conductive, touching the touchscreen changes the electromagnetic field. This change in the magnetic field controls the interaction with the device. But if you are wearing gloves, the fabric insulates the finger. And this is why an interaction with the screen is no longer possible.

By using conductive yarn you can re-establish the connection between your finger and the smartphone!

What is conductive yarn?

Conductive yarn is woven with metals such as steel or coated with silver, for example. Woven yarn is more supple and therefore easier to embroider, coated yarn is more brittle.

You need:

- darning needle* (pointed for leather and Fleece gloves, blunt for knitted gloves)
- small adhesive dots*
- conductive yarn*
- tailor's chalk / white crayon
- wooden sticks*
- gloves

*enclosed

